

EAST ELEVATION

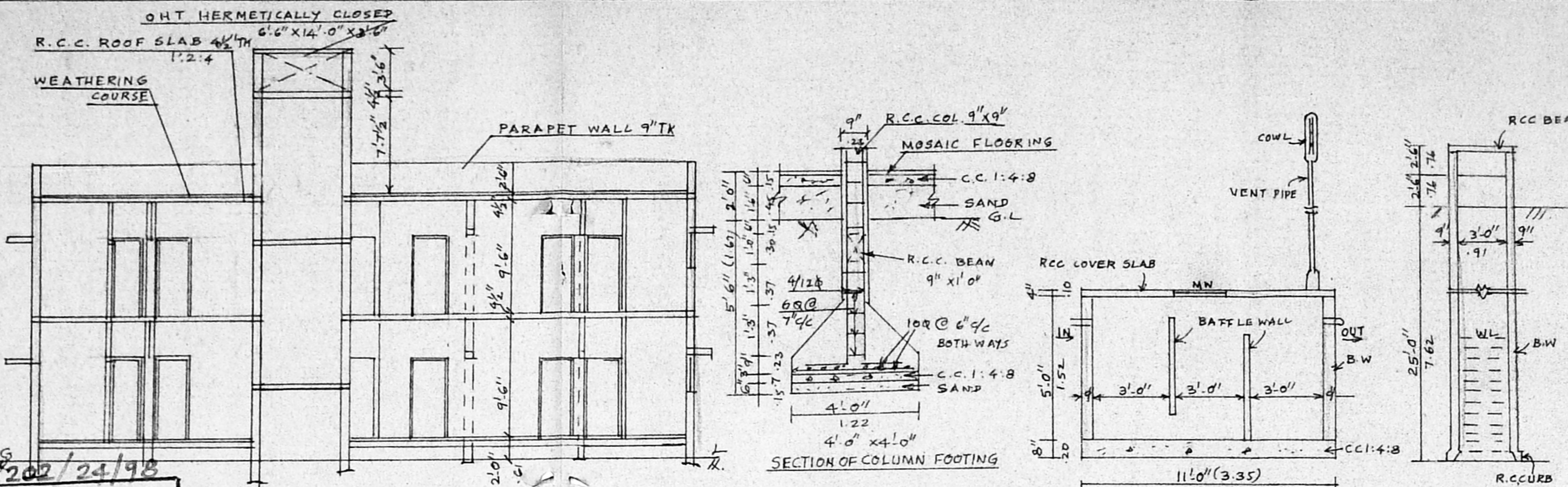

SECTION ON 'X Y'

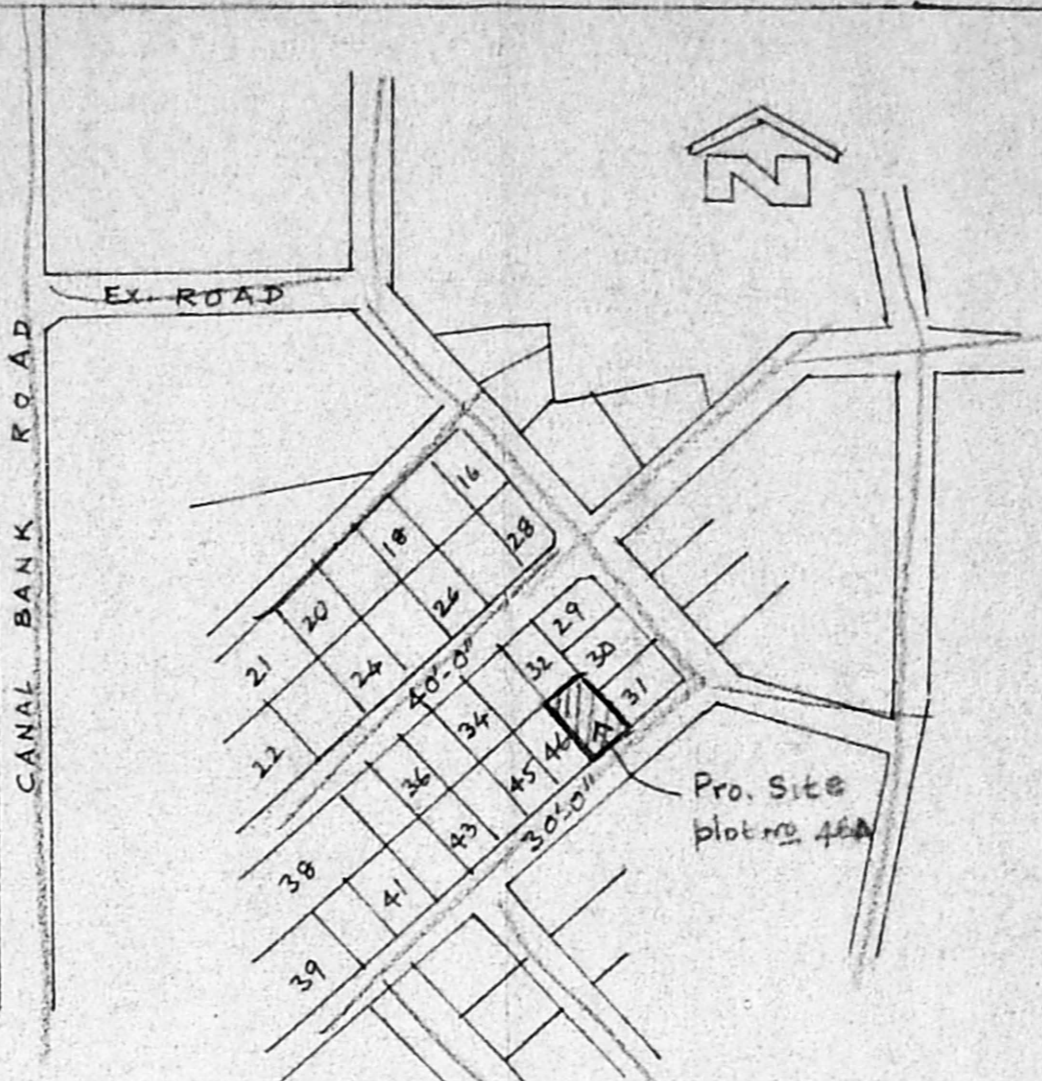

KEY PLAN

REFERENCE			
D	DOOR	3'-0" x 6'-6"	1.00 x 1.98
D1	DOOR	3'-0" x 6'-6"	0.91 x 1.98
D2	DOOR	2'-6" x 6'-6"	0.76 x 1.98
W	WINDOW	3'-0" x 4'-0"	0.91 x 1.22
W1	WINDOW	4'-0" x 4'-0"	1.22 x 1.22
W2	WINDOW	5'-0" x 5'-0"	1.52 x 1.52
W3	WINDOW	5'-0" x 4'-0"	1.52 x 1.22
V	VENTILATOR	3'-0" x 2'-0"	0.91 x 0.61
J	R.C.C. JALI	6'-0" x 7'-6"	1.98 x 2.29
STAIRCASE WIDTH 3'-3" (100) TREAD 9" RISE 7"			
PLOT COVERAGE 59%, F.S.I = 1.18			

AREA/COLOUR INDEX	
PROPOSED SITE	2800 SRF 260.12m ²
PROPOSED CONSTRUCTION	
GROUND FLOOR	= 1650 SRF 153.29m ²
FIRST FLOOR	= 1650 SRF 153.29m ²
PLOT COVERAGE	= 58.93% F.S.I = 1.178
ROADS	
SEWERAGE LINE	

Planning Permit No. A/25202/24/98
APPROVED
 SUBJECT TO THE CONDITIONS IN THIS OFFICE LETTER
 No. A/29107/97 Date 2.98
 FOR MEMBER SECRETARY
 CHENNAI METROPOLITAN CORPORATION
 DEVELOPMENT & CONSTRUCTION DEPARTMENT
 CHENNAI - 600 008

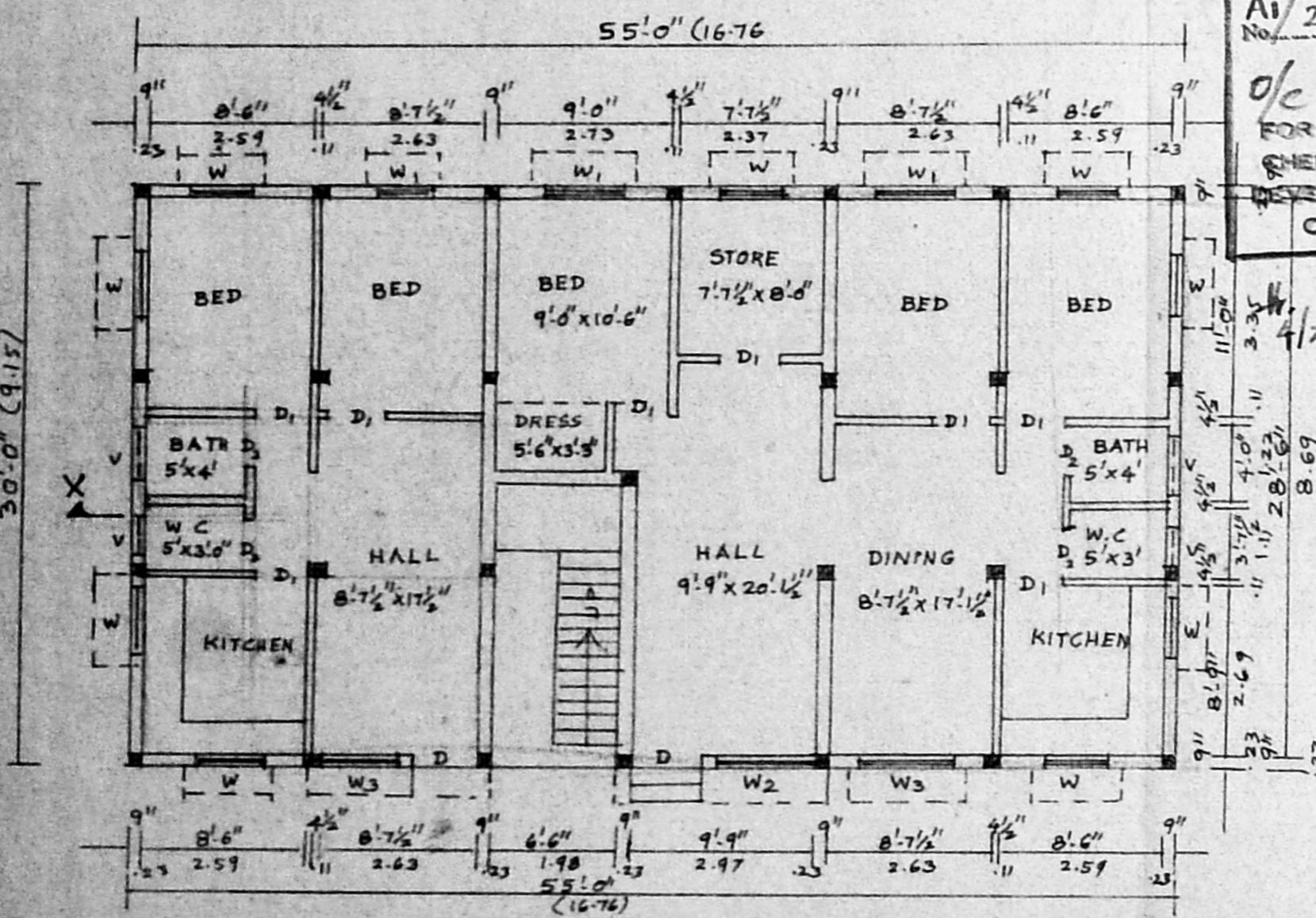

GROUND FLOOR PLAN

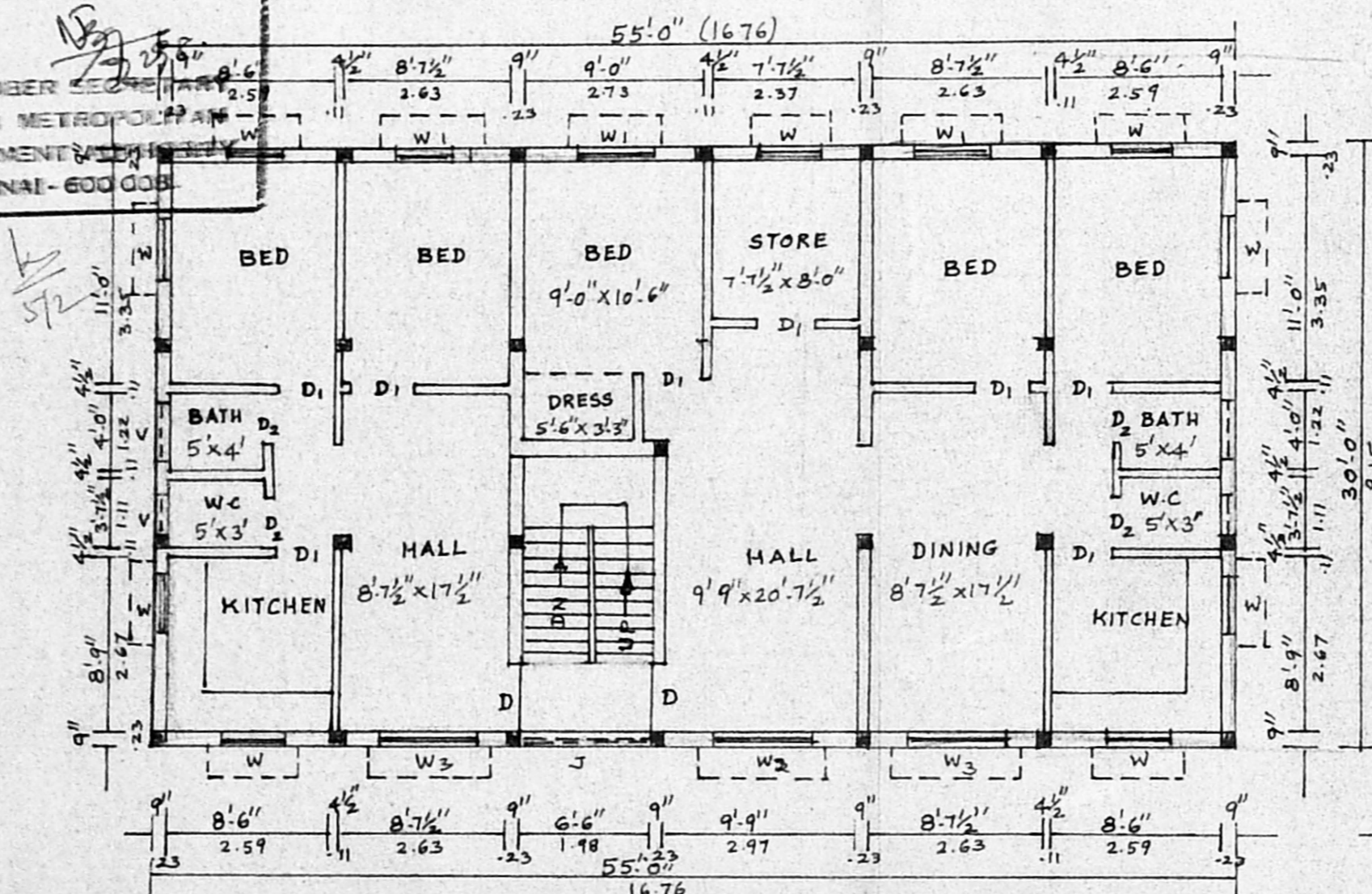

FIRST FLOOR PLAN

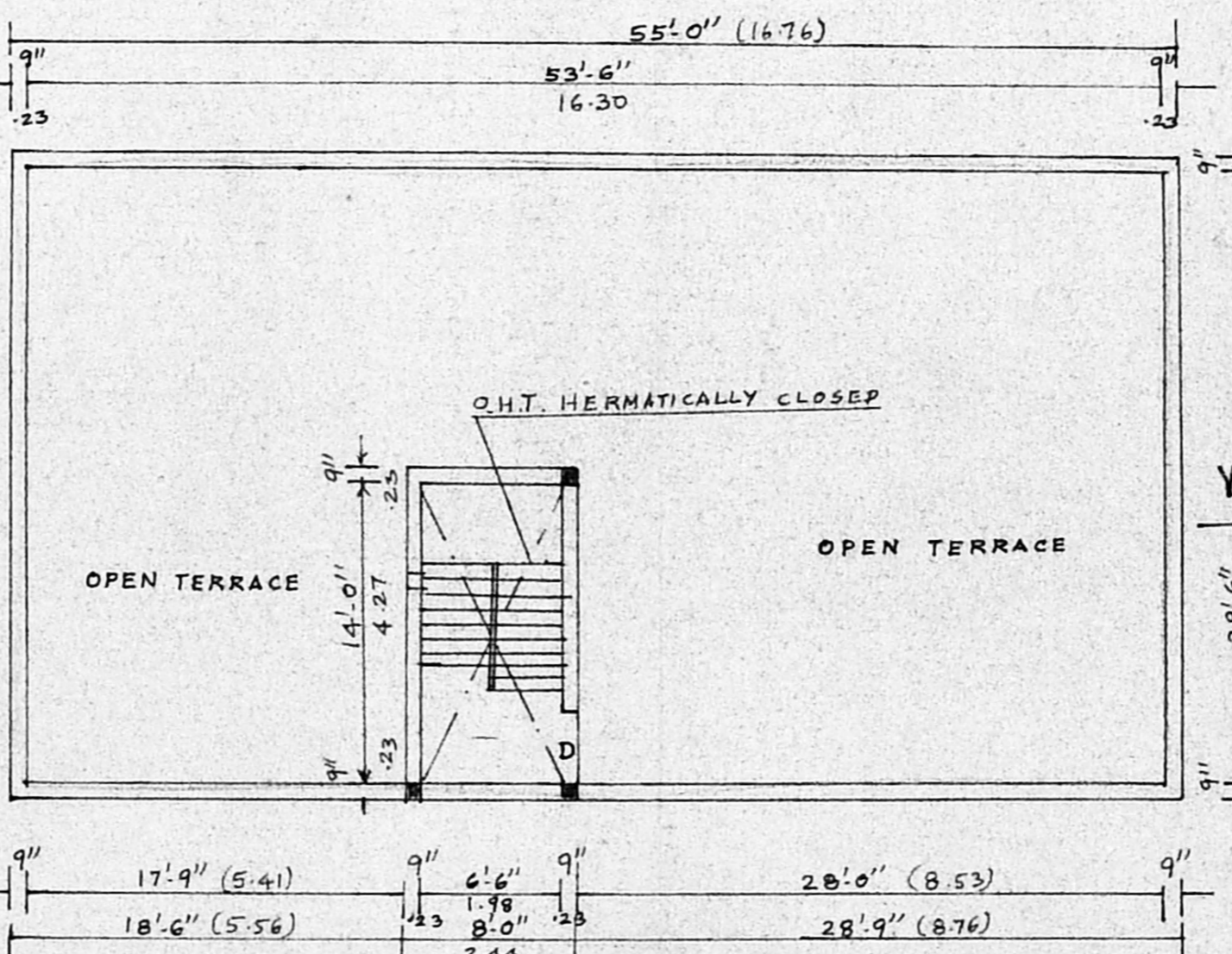

OPEN TERRACE PLAN

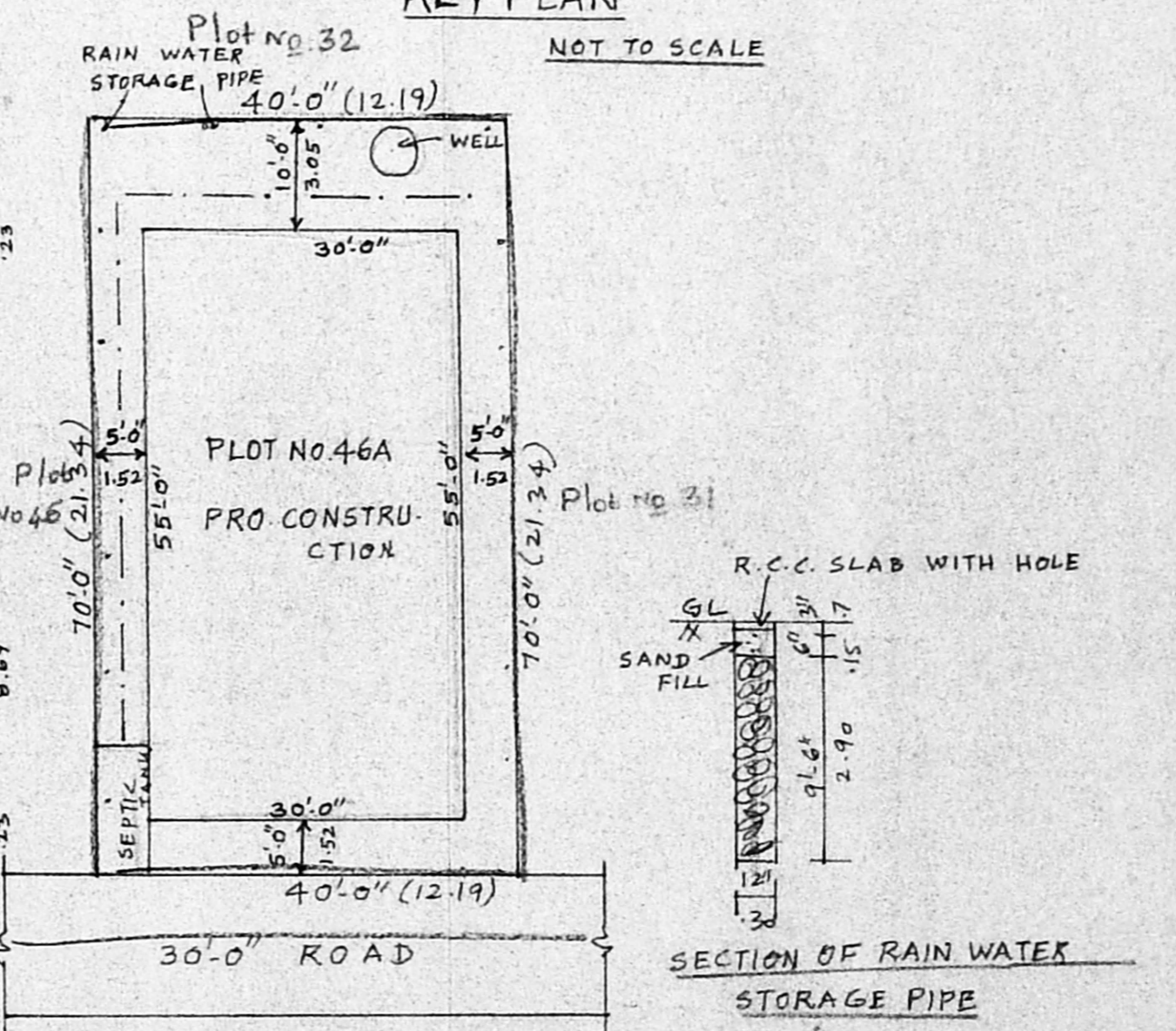

SITE PLAN SCALE 1" = 16'0" (1:200)

PLAN SHOWING THE PROPOSED CONSTRUCTION OF DWELLING HOUSES AT PLOT NO: 46A, S. NO. 257/5 & 257/6, SWAMINATHA NAGAR, APPROVED LAYOUT AS PER LPDM/DDTP No 135/75 KOTTIVAKKAM VILLAGE TAMBARAM TALUK, CHENNAI - 600041

SCALE: 1" = 8'0" (1:100)

APPLICANT
 K. Nagaraj
 LICENSED SURVEYOR
 205, RAMANATHAN STREET
 OFF. MANDALAM Rly Station
 T. NAGAR MADRAS 600017

LICENSED SURVEYOR